

COPERCHI E ACCESSORI TANK LIDS AND ACCESSORIES TAPAS Y ACCESORIOS



LIDS

Coperchi di svariati tipi, filettati o a baionetta, fino al tipo ribaltabile a 180°, trovano applicazione, insieme ai filtri a cestello, nelle cisterne delle più svariate misure e configurazioni.

I coperchi costruiti in Polipropilene assicurano una ottima resistenza ai raggi U.V. ed una durata pressochè illimitata nel tempo.

Various types of lids, hinged up to 180°, threaded or bayonet lock, can be used, along with the filter baskets, with the largest range of different sizes and configuration of tanks.

The lids are made of U.V. resistant Polypropylene to offer an almost unlimited life.

Tapas de diferentes tipos, roscadas, de bayoneta o incluso rebatible a 180°, pueden aplicarse, junto a los filtros de fondo, en los tanques de las más variadas medidas y configuraciones.

Las tapas son realizadas en Polipropileno resistente a los rayos U.V. para asegurar una duración prácticamente ilimitada en el tiempo.

Legenda dei simboli - Symbols - Leyenda simbolos



flat

Fissaggio superiore
For flat surfaces
Para superficies planas



side

Fissaggio laterale
Side connection
Fijación lateral



twin gasket

Superfici piane, con doppia guarnizione
Twin gasket ring for flat surfaces
Para superficies planas con doble junta

new

Nuovi prodotti
New items
Nuevos productos



Nuovi prodotti
New items
Nuevos productos



LIDS

COPERCHI RIBALTABILI HINGED TANK LIDS TAPAS REBATIBLES

Coperchio ribaltabile 180° per serbatoi

Coperchio ribaltabile 180° per atomizzatori e gruppi da diserbo completo di anello per fissaggio sul serbatoio.

- Versione con sfiato a labirinto.
- Versione con valvola di sfiato con galleggiante per lavoro su terreni in pendio.
- Disponibili con e senza bloccaggio.
- Disponibili sia con fissaggio laterale che per superfici piane.
- Guarnizione di tenuta sul coperchio di serie.
- **Guarnizione anello da ordinare separatamente.**
- Bloccaggio a baionetta su sei punti per una perfetta chiusura.
- Ribaltamento a 180° per evitare sforzi sul coperchio e sul serbatoio.
- Possibilità di montare la serie di filtri a cestelli in plastica o in acciaio di ns. produzione.

Tank overturning lid 180°

Overturning lid 180° with fixing ring to the tank.

- Labyrinth breather version.
- Air valve with float version to work on sloped ground.
- Available with and without blocking.
- Available with lateral fixing and for flat surfaces.
- Seal on the lid as standard.
- **Ring gasket which must be ordered separately.**
- Bayonet blocking system on six points for perfect lockup.
- 180° overturn to prevent stress on lid and tank.
- Possibility to mount the basket filter series made of plastic or steel of our production.

Tapa rebatible 180° para tanque

Tapa rebatible 180° con anillo de fijación al tanque.

- Versión con ventilación en forma de laberinto.
- Versión con válvula de aireación con flotador para trabajos en terrenos con pendientes.
- Disponibles con y sin bloqueo.
- Disponibles ya sea con fijación lateral o para superficies planas.
- Junta de estanqueidad de serie en la tapa.
- **Junta superior que debe ordenarse por separado.**
- Bloqueo tipo bayoneta en seis puntos para un cierre perfecto.
- Apertura 180° para evitar esfuerzos sobre la tapa y sobre el depósito.
- Posibilidad de montar la serie de filtros de cesta de plástico o de acero de nuestra producción.



new design

Versione senza bloccaggio di chiusura
Version without lockup blocking
Versión sin bloqueo de cierre

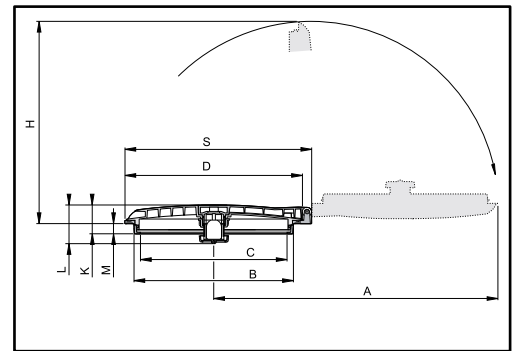

Versione con bloccaggio di chiusura
Version with lockup blocking
Versión con bloqueo de cierre

new design

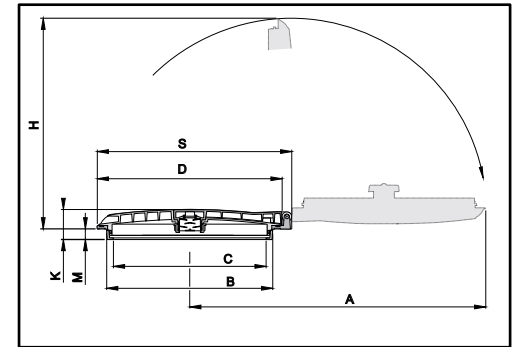

Presu ridisegnata e migliorata per facilitare l'apertura e la chiusura del coperchio
Redesigned and improved grip to facilitate opening and closing of the lid
Manija rediseñada y mejorada para facilitar la apertura y cierre de la tapa

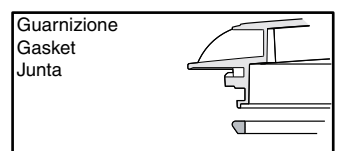
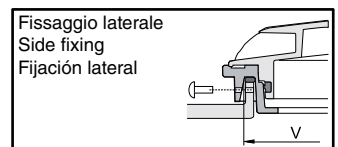
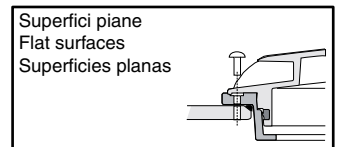
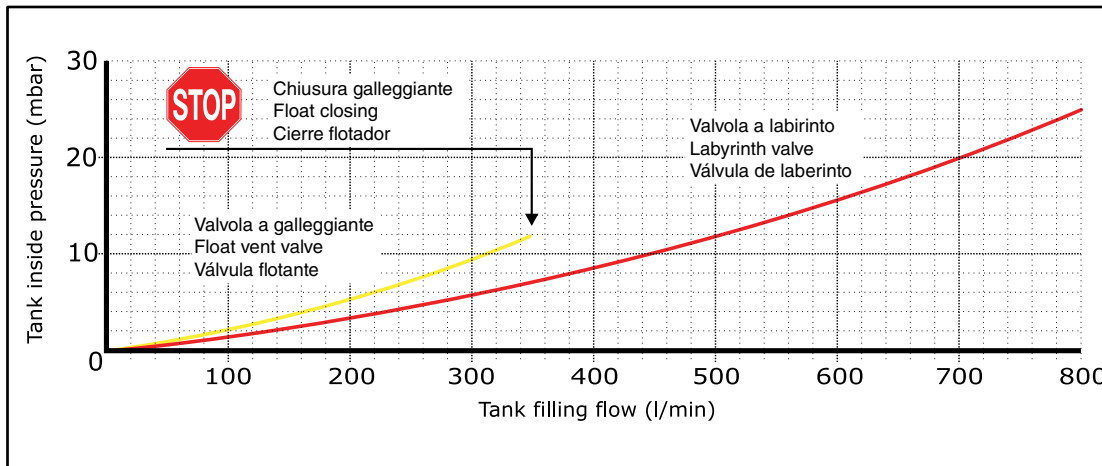



Sfiato con galleggiante

Float vent valve

Válvula con flotante

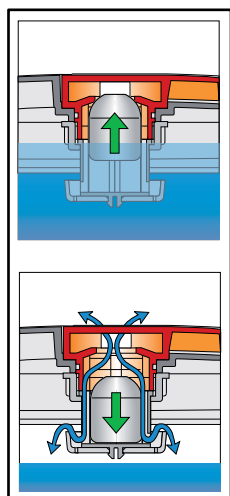

Con bloccaggio
Lockable
Con bloqueo

COD. CODE CÓD.		D (mm)	B (mm)	C (mm)	K (mm)	L (mm)	M (mm)	H (mm)	S (mm)	A (mm)	V (mm)	COD. EPDM EPDM CODE CÓD EPDM	COD. CODE CÓD		
356 040		---									---	350 440.020	300 120 300 330		
356 041		●	∅ 367	∅ 320	∅ 290	68	104	26.5	404	390	572			---	
356 045		---									336				
356 046		●									336				
356 060		---									---	350 460.020	300 126 300 130 300 134		
356 061		●	∅ 462	∅ 415	∅ 382	75	105	26.5	501	486	713			---	
356 065		---									428				
356 066		●									428				

1
La guarnizione coperchio è già compresa nel codice
The cover gasket is already included in the code
La junta de la tapa ya está incluida en el código

Accessori da ordinare separatamente
Accessories to order separately
Accesorios a pedir por separado

Sfiato con labirinto

Labyrinth valve

Válvula con laberinto

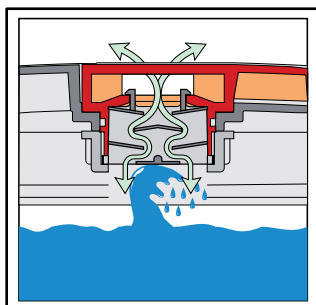

Con bloccaggio
Lockable
Con bloqueo

COD. CODE CÓD.		D (mm)	B (mm)	C (mm)	K (mm)	M (mm)	H (mm)	S (mm)	A (mm)	V (mm)	COD. EPDM EPDM CODE CÓD EPDM	COD. CODE CÓD			
356 240		---									---	350 440.020	300 120 300 330		
356 241		●	∅ 367	∅ 320	∅ 290	68	26.5	404	390	572	---				
356 245		---									336				
356 246		●									336				
356 260		---									---	350 460.020	300 126 300 130 300 134		
356 261		●	∅ 462	∅ 415	∅ 382	75	26.5	501	486	713	---				
356 265		---									428				
356 266		●									428				

1
La guarnizione coperchio è già compresa nel codice
The cover gasket is already included in the code
La junta de la tapa ya está incluida en el código

Accessori da ordinare separatamente
Accessories to order separately
Accesorios a pedir por separado

Guarniz. di ricambio
Spare gasket
Junta de recambio

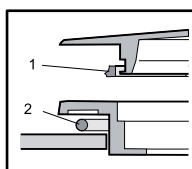

Tipo Type Tipo	COD. CODE CÓD.	per for para	Materiale Material Material
1	356 2040.090	∅ 367	NBR
1	356 2060.090	∅ 462	NBR
2	350 440.020	∅ 367	EPDM
2	350 460.020	∅ 462	EPDM



**COPERCHI
LIDS
TAPAS**

SMOOTH LINE 2

Coperchio chiuso serie "Smooth-line 2"

"Smooth-line 2" closed lid

Tapa cerrada serie "Smooth-line 2"

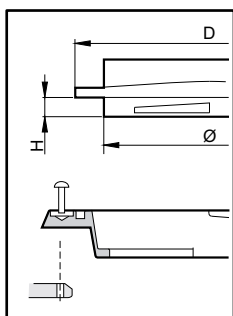

Diametro Diameter Diametro D mm	Coperchio Lid Tapa	Anello Ring Aro	Ø		H mm	Guarnizione Gasket Junta	Filtro Filter Filtro
			mm	inches			
140	352 2100	350 401	110	4.3	10	352 000.020	300 304



Fissaggio superiore
For flat surfaces
Para superficies planas

Accessori da ordinare separatamente
Accessories to order separately
Accesorios a pedir por separado

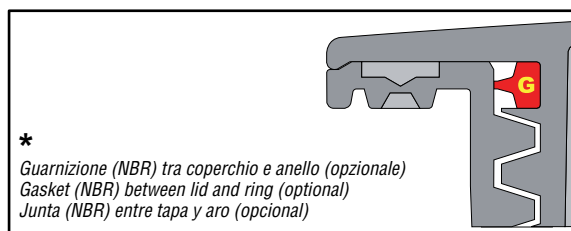
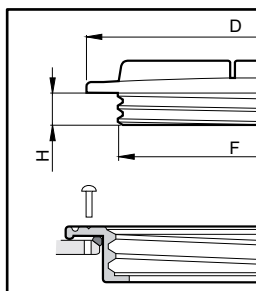

*
Guarnizione (NBR) tra coperchio e anello (opzionale)
Gasket (NBR) between lid and ring (optional)
Junta (NBR) entre tapa y aro (opcional)



Fissaggio superiore
For flat surfaces
Para superficies planas

Diametro Diameter Diametro D mm	Kit Coperchio + Anello Kit Lid + Ring Kit Tapa + Aro	Coperchio Lid Tapa	Anello Ring Aro	F		H mm	Guarnizione* Gasket* Junta*	Filtro Filter Filtro
				mm	inches			
250	351 0120	352 2120	350 2420	210	8.2	31	352 2120.020	300 110 300 116 300 315
355	351 0140	352 2140	350 2440	313	12.3	31	352 2140.020	300 120 300 330
455	351 0160	352 2160	350 2460	410	16.1	25	352 2160.020	300 126 300 130 300 134
620	351 0180	352 2180	350 480	567	22.3	30	---	---

Accessori da ordinare separatamente
Accessories to order separately
Accesorios a pedir por separado

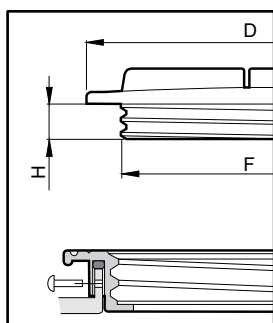

Accessori da ordinare separatamente
Accessories to order separately
Accesorios a pedir por separado



Fissaggio laterale
Side connection
Fijación lateral

Diametro Diameter Diametro D mm	Kit Coperchio + Anello Kit Lid + Ring Kit Tapa + Aro	Coperchio Lid Tapa	Anello Ring Aro	F		H mm	Guarnizione* Gasket* Junta*	Filtro Filter Filtro
				mm	inches			
250	351 6120	352 2120	350 2520	210	8.2	31	352 2120.020	300 110 300 116 300 315
355	351 6140	352 2140	350 2540	313	12.3	31	352 2140.020	300 120 300 330
455	351 6160	352 2160	350 2560	410	16.1	25	352 2160.020	300 126 300 130 300 134



**COPERCHI
LIDS
TAPAS**

SMOOTH LINE 2

MISTRAL

Coperchio filettato serie "Smooth-line 2" con sfiato a labirinto estraibile "MISTRAL"

Realizzato secondo le attuali norme antinquinamento è munito di un gruppo valvola a doppio sfiato che permette lo svuotamento rapido del serbatoio a coperchio chiuso anche con pompa di grossa portata.

"Smooth-line 2" threaded lids with removable labyrinth breather "MISTRAL"

Made to current anti-pollution standards, the lid is equipped with a double breather valve to empty the tank quickly with the lid closed, even with a high-delivery pump.

Tapas roscadas serie "Smooth-line 2" con respiradero de laberinto extraíble "MISTRAL"

Realizada según las actuales normas anticontaminación, está provista de un grupo válvula de doble respiradero que permite el vaciado rápido de la cisterna con la tapa cerrada, incluso con bombas de gran caudal.

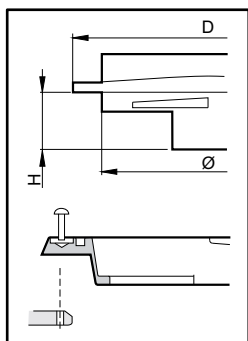

Diametro Diameter Diametro D mm	Kit coperchio + Anello Kit lid + Ring Kit Tapa + Aro	Coperchio Lid Tapa	Anello Ring Aro	Ø		H	Guarnizione Gasket Junta	Filtro Filter Filtro
140	351 0000	352 2000	350 401	mm	inches	mm	352 000.020	300 304



Fissaggio superiore
For flat surfaces
Para superficies planas

Accessori da ordinare separatamente
Accessories to order separately
Accesorios a pedir por separado

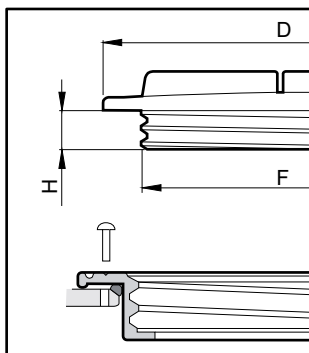

Fissaggio superiore
For flat surfaces
Para superficies planas

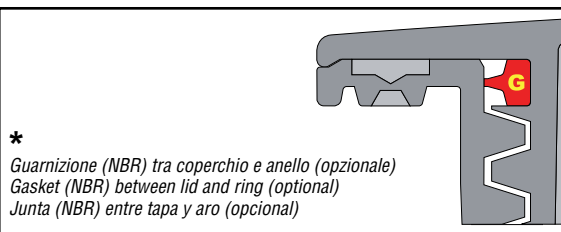

Diametro Diameter Diametro D mm	Kit Coperchio + Anello Kit Lid + Ring Kit Tapa + Aro	Coperchio Lid Tapa	Anello Ring Aro	F		H	Guarnizione* Gasket* Junta*	Filtro Filter Filtro
355	351 0040	352 2040	350 2440	mm	inches	mm	352 2140.020	300 120 300 330
455	351 0060	352 2060	350 2460	410	16.1	25	352 2160.020	300 126 300 130 300 134
620	351 0080	352 2080	350 480	567	22.3	30	---	---

Accessori da ordinare separatamente
Accessories to order separately
Accesorios a pedir por separado

MISTRAL

COPERCHI
LIDS
TAPAS

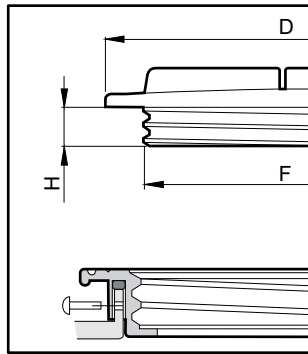

Fissaggio laterale
Side connection
Fijación lateral

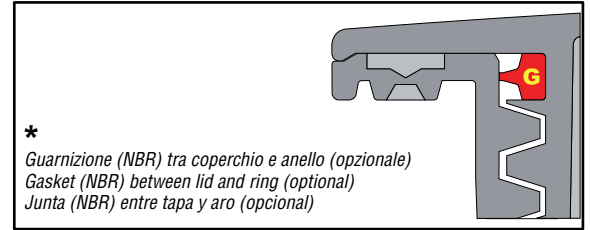

*
Guarnizione (NBR) tra coperchio e anello (opzionale)
Gasket (NBR) between lid and ring (optional)
Junta (NBR) entre tapa y aro (opcional)

Diametro Diameter D mm	Kit coperchio + Anello Kit lid + Ring Kit Tapa + Aro	Coperchio Lid Tapa	Anello Ring Aro	F		H	Guarnizione* Gasket* Junta*	Filtro Filter Filtro
				mm	inches			
355	351 6040	352 2040	350 2540	313	12.3	31	352 2140.020	300 120 300 330
455	351 6060	352 2060	350 2560	410	16.1	25	352 2160.020	300 126 300 130 300 134

Accessori da ordinare separatamente
Accessories to order separately
Accesorios a pedir por separado

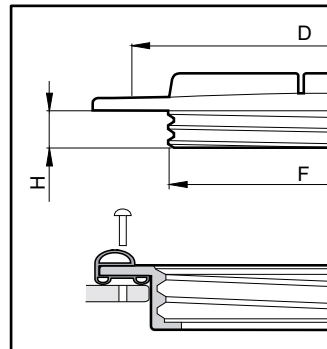

superfici piane, con doppia guarnizione
twin gasket ring for flat surfaces
para superficies planas con doble junta

Diametro Diameter D mm	Kit coperchio + Anello Kit lid + Ring Kit Tapa + Aro	Coperchio Lid Tapa	Anello Ring Aro	F		H	Filtro Filter Filtro
				mm	inches		
355	351 4040	352 2040	350 640	313	12.3	31	300 120 300 330
455	351 4060	352 2060	350 660	410	16.1	25	300 126 300 130 300 134
620	351 4080	352 2080	350 680	567	22.3	30	---

Accessori da ordinare separatamente
Accessories to order separately
Accesorios a pedir por separado

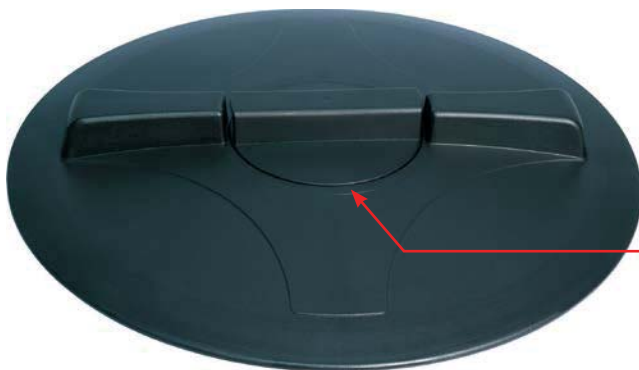

COD. / CODE / CÓD.

352 000.020

Guarnizione (EPDM) tra valvola e coperchio (opzionale)
Gasket (EPDM) between valve and lid (optional)
Junta (EPDM) entre válvula y tapa (opcional)



**COPERCHI
LIDS
TAPAS**

SMOOTH LINE 2

GHIBLI

Coperchio filettato serie "Smooth-line 2" con sfiato fisso a labirinto "GHIBLI"

Realizzato secondo le attuali norme antinquinamento è munito di un gruppo valvola a doppio sfiato che permette lo svuotamento rapido del serbatoio a coperchio chiuso anche con pompa di grande portata.

"Smooth-line 2" threaded lids with fixed labyrinth breather "GHIBLI"

Made to current anti-pollution standards, the lid is equipped with a double breather valve to empty the tank quickly with the lid closed, even with a high-delivery pump.

Tapas roscadas serie "Smooth-line 2" con respiradero fijo de laberinto "GHIBLI"

Realizada según las actuales normas anticontaminación, está provista de un grupo válvula de doble respiradero que permite el vaciado rápido de la cisterna con la tapa cerrada, incluso con bombas de gran caudal.

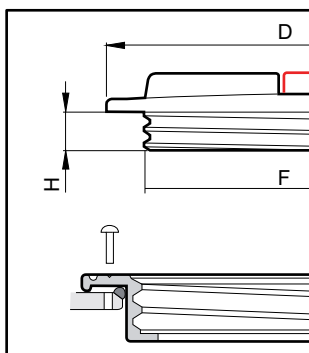

*Fissaggio superiore
For flat surfaces
Para superficies planas*

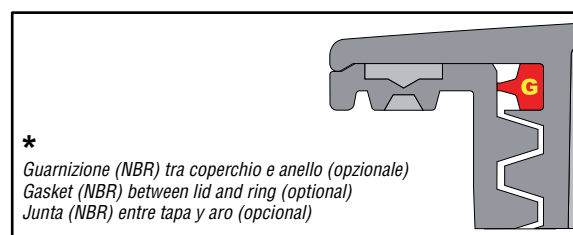

*
*Guarnizione (NBR) tra coperchio e anello (opzionale)
Gasket (NBR) between lid and ring (optional)
Junta (NBR) entre tapa y aro (opcional)*

Diametro Diameter Diametro D mm	Kit coperchio + Anello Kit lid + Ring Kit Tapa + Aro	Coperchio Lid Tapa	Anello Ring Aro	F		H	Guarnizione* Gasket* Junta*	Filtro Filter Filtro
				mm	inches			
250	351 0221	352 2221	350 2420	210	8.2	31	352 2120.020	300 110 300 116 300 315
355	351 0241	352 2241	350 2440	313	12.3	31	352 2140.020	300 120 300 330
455	351 0261	352 2261	350 2460	410	16.1	25	352 2160.020	300 126 300 130 300 134

**Accessori da ordinare separatamente
Accessories to order separately
Accesorios a pedir por separado**

GHIBLI

COPERCHI
LIDS
TAPAS

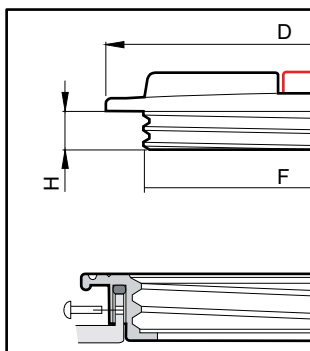

Fissaggio laterale
Side connection
Fijación lateral

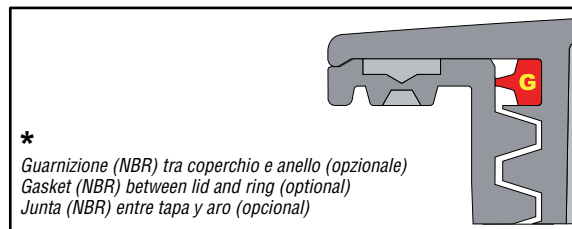

Diametro Diameter D mm	Kit coperchio + Anello Kit lid + Ring Kit Tapa + Aro	Coperchio Lid Tapa	Anello Ring Aro	F		H	Guarnizione* Gasket* Junta*	Filtro Filter Filtro
				mm	inches			
250	351 6221	352 2221	350 2520	210	8.2	31	352 2120.020	300 110 300 116 300 315
355	351 6241	352 2241	350 2540	313	12.3	31	352 2140.020	300 120 300 330
455	351 6261	352 2261	350 2560	410	16.1	25	352 2160.020	300 126 300 130 300 134

Accessori da ordinare separatamente
Accessories to order separately
Accesorios a pedir por separado

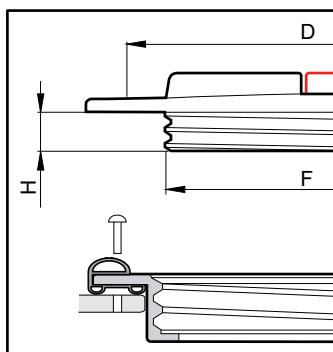

superfici piane, con doppia guarnizione
twin gasket ring for flat surfaces
para superficies planas con doble junta

Diametro Diameter D mm	Kit coperchio + Anello Kit lid + Ring Kit Tapa + Aro	Coperchio Lid Tapa	Anello Ring Aro	F		H	Filtro Filter Filtro
				mm	inches		
250	351 4221	352 2221	350 620	210	8.2	31	300 110 300 116 300 315
355	351 4241	352 2241	350 640	313	12.3	31	300 120 300 330
455	351 4261	352 2261	350 660	410	16.1	25	300 126 300 130 300 134

Accessori da ordinare separatamente
Accessories to order separately
Accesorios a pedir por separado



**COPERCHI
LIDS
TAPAS**

Coperchio chiuso



Closed lid

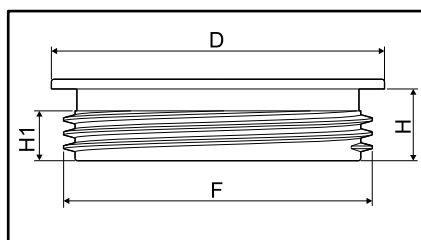

Tapa cerrada

COD. CODE CÓD.	D (mm)	F (mm)	H (mm)	H1 (mm)
C00 001	137	127	30	21

**ANELLI PER COPERCHI
LID RINGS
AROS PARA TAPAS**

Anello filettato per superfici piane



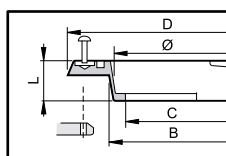

Threaded ring for flat surfaces

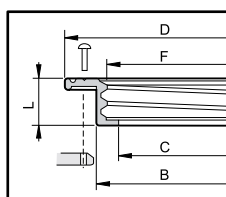

Aro roscado para superficies planas

COD. CODE CÓD.	D (mm)	Ø (mm)	(inches)	B (mm)	C (mm)	L (mm)	 COD. / CODE / CÓD
350 401	159	120	4.7	125	112	17	300 304



COD. CODE CÓD.	D (mm)	F (mm)	(inches)	B (mm)	C (mm)	L (mm)	 COD. / CODE / CÓD
350 2420	255	210	8.2	215	192	38	300 110 300 116 300 315
350 2440	360	313	12.3	320	290	38	300 120 300 330
350 2460	462	410	16.1	415	382	35	300 126 300 130 300 134
350 480	620	567	22.3	575	540	41	---

Anello filettato fissaggio laterale



Threaded ring with side connection

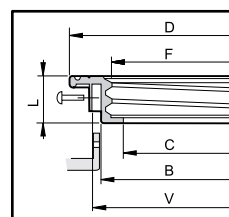

Aro roscado fijación lateral

COD. CODE CÓD.	D (mm)	F (mm)	(inches)	B (mm)	C (mm)	L (mm)	V (mm)	 COD. / CODE / CÓD
350 2520	255	210	8.2	215	192	38	230	300 110 300 116 300 315
350 2540	360	313	12.3	320	290	38	335	300 120 300 330
350 2560	462	410	16.1	415	382	35	430	300 126 300 130 300 134

Guarnizioni di tenuta tra serbatoio e anello

Sealing gaskets between tank and ring

Juntas de sellado entre tanque y aro

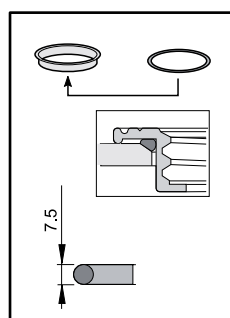

COD. CODE CÓD.	Per anelli For ring Para aros
350 401.020	350 401
350 420.020	350 2420 350 2520
350 440.020	350 2440 350 2540
350 460.020	350 2460 350 2560
350 480.020	350 480



**COPERCHI FILETTO FEMMINA PER SERBATOI
FEMALE THREADED TANK LIDS
TAPAS DE ROSCA HEMBRA PARA CISTERNAS**

354

Coperchio con valvola di sfiato a membrana completo di guarnizione

Lid with diaphragm breather valve complete with gasket

Tapa con membrana de respiradero completo con junta

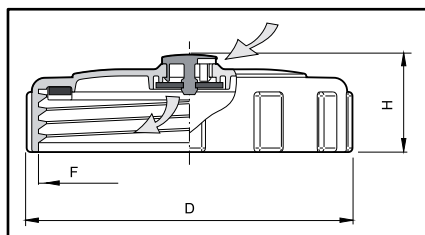

COD. CODE CÓD.	D (mm)	F (mm) (inches)	H (mm)
354 230	122	113 4.5	36.5

Guarniz. di ricambio (NBR)
Spare gasket (NBR)
Junta de recambio (NBR)

COD. CODE CÓD.
354 030.020

Coperchio chiuso completo di guarnizione

Closed lid with gasket

Tapa cerrada con junta

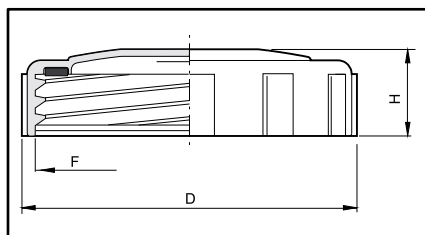

COD. CODE CÓD.	D (mm)	F (mm) (inches)	H (mm)
354 130	122	113 4.5	32

Guarniz. di ricambio (NBR)
Spare gasket (NBR)
Junta de recambio (NBR)

COD. CODE CÓD.
354 030.020

Coperchio chiuso trasparente completo di guarnizione

Transparent closed lid with gasket

Tapa cerrada transparente con junta

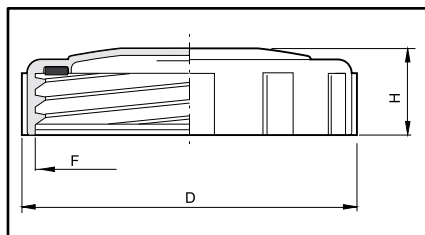

COD. CODE CÓD.	D (mm)	F (mm) (inches)	H (mm)
354 130T	122	113 4.5	32

Guarniz. di ricambio (NBR)
Spare gasket (NBR)
Junta de recambio (NBR)

COD. CODE CÓD.
354 030.020

Coperchio con sfiato a molla completo di guarnizione

Lid with spring breather and gasket

Tapa con respiradero de muelles con junta

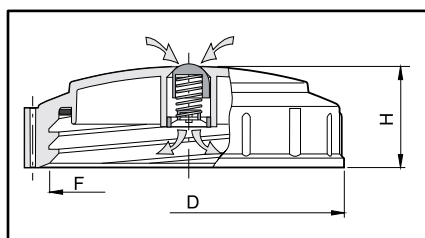

COD. CODE CÓD.	D (mm)	F (mm) (inches)	H (mm)
354 2010	166	154 6	47

Guarniz. di ricambio (NBR)
Spare gasket (NBR)
Junta de recambio (NBR)

COD. CODE CÓD.
354 2010.020

Coperchio chiuso completo di guarnizione

Closed lid with gasket

Tapa cerrada con junta

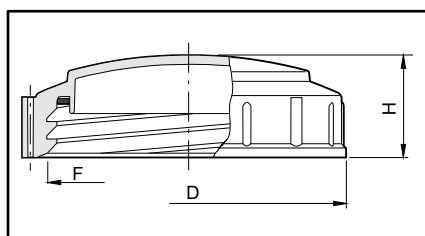

COD. CODE CÓD.	D (mm)	F (mm) (inches)	H (mm)
354 2110	166	154 6	47

Guarniz. di ricambio (NBR)
Spare gasket (NBR)
Junta de recambio (NBR)

COD. CODE CÓD.
354 2010.020



Coperchio con foro per valvola di sfiato

Lid with hole for breather valve

Tapa con orificio para válvula de respiradero

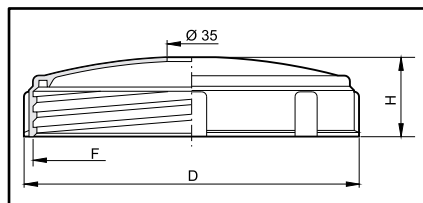

Guarniz. opzionale (EPDM)
Optional gasket (EPDM)
Junta opcional (EPDM)

COD. CODE CÓD.	D (mm)	F (mm)	(inches)	H (mm)
354 320	240	226	9	57

COD. CODE CÓD.
G 11069

È possibile montare le valvole di sfiato cod. 504 201 o 504 203 (pag. 330)
This lid can also be fitted with breather valves 504201 or 504203 (page 330)
Se pueden montar las válvulas de respiradero cód. 504 201 ó 504 203 (pág. 330)

Coperchio con valvola di sfiato a membrana

Lid with diaphragm breather valve

Tapa con membrana de respiradero

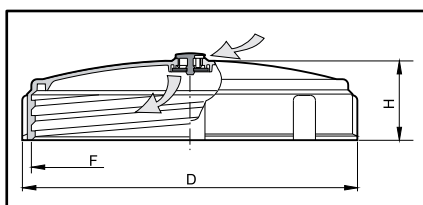

Guarniz. opzionale (EPDM)
Optional gasket (EPDM)
Junta opcional (EPDM)

COD. CODE CÓD.	D (mm)	F (mm)	(inches)	H (mm)
354 220	240	226	9	58.5

COD. CODE CÓD.
G 11069

Coperchio chiuso

Closed lid

Tapa cerrada

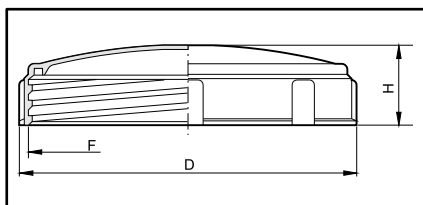

Guarniz. opzionale (EPDM)
Optional gasket (EPDM)
Junta opcional (EPDM)

COD. CODE CÓD.	D (mm)	F (mm)	(inches)	H (mm)
354 120	240	226	9	58.5

COD. CODE CÓD.
G 11069

Coperchio chiuso "DOT" completo di
guarnizione

Closed lid "DOT" with gasket

Tapa cerrada "DOT" con junta

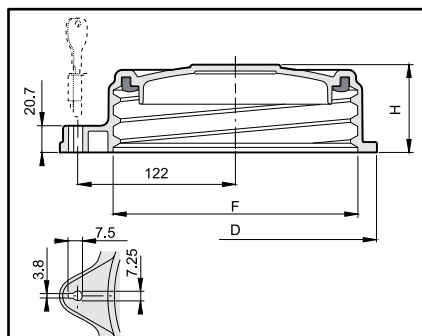

Guarniz. di ricambio (EPDM)
Spare gasket (EPDM)
Junta de recambio (EPDM)

COD. CODE CÓD.	D (mm)	F (mm)	(inches)	H (mm)
354 142	219	189	7.5	68

COD. CODE CÓD.
354 040.020



**FILTRI IMMISSIONE SERBATOIO
TANK FILLING FILTER
FILTROS LLENADO TANQUES**

300

Filtro a sacco (rete 18 mesh)

Basket filter (screen 18 mesh)

Filtros en forma de sacco (18 mesh)

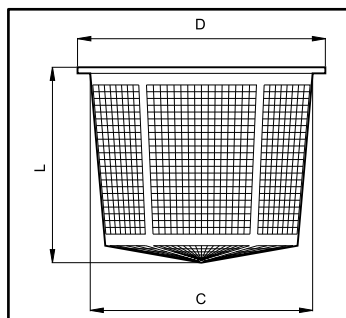

COD. CODE CÓD.	D (mm)	C (mm)	L (mm)	per - for - para
300 140	140	127	203	354 2010 354 2110
300 101	295	285	230	---
300 110	203	188	120	350 2420
300 116	203	188	235	350 2520
300 112	210	188	120	---
300 118	210	188	235	---
300 120	300	288	245	350 640 350 2440 350 2540
				356 040 356 041 356 045 356 046
				350 660 350 2460 350 2560
				356 060 356 065
300 126	400	380	185	350 660 350 2460 350 2560
300 130	400	380	275	---
300 134	400	380	330	356 060 356 065
300 128	410	380	185	---
300 132	410	380	275	
300 136	410	380	330	
300 114	194	188	235	
300 119	230	188	235	Versioni speciali
300 122	322	288	245	Special versions
300 124	337	288	245	Versiones especiales

Filtro a sacco in polipropilene

Polypropylene basket filter

Filtro en forma de sacco de polipropileno

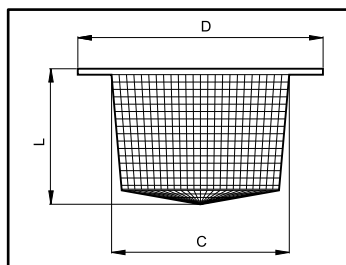

COD. CODE CÓD.	D (mm)	C (mm)	L (mm)
300 212	208	162	115

Filtro a tazza

Cup filter

Filtro de taza

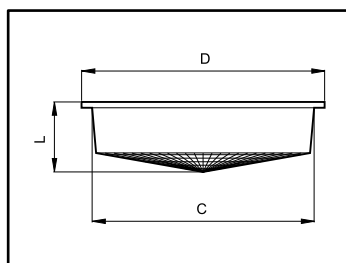

COD. CODE CÓD.	D (mm)	C (mm)	L (mm)	per - for - para
300 309	104	94	35	---
300 304	118	108	40	350 401
300 310	194	187	60	---
300 315	204	187	60	350 2420 350 2520 350 620
300 320	208	194	40	---
300 330	302	288	46	350 640 350 2440 350 2540
				356 040 356 041 356 045 356 046
300 335	322	288	46	---



VALVOLE DI SFIATO BREATHER VALVES VÁLVULAS DE RESPIRADERO

Valvola di sfiato a labirinto

Labyrinth breather valve

Válvula respiradero de laberinto



COD.
CODE
CÓD.
504 220

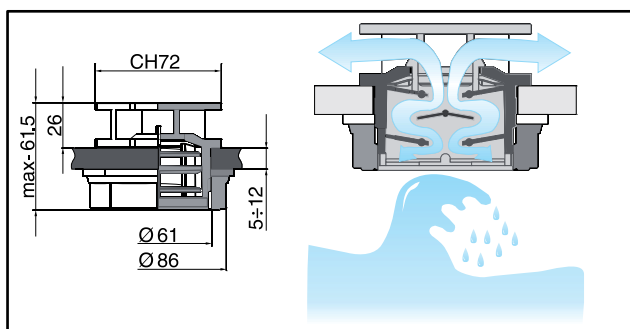

Valvola di sfiato a sfera galleggiante

Floating ball breather valve

Válvula respiradero de bola flotante



COD.
CODE
CÓD.
504 210

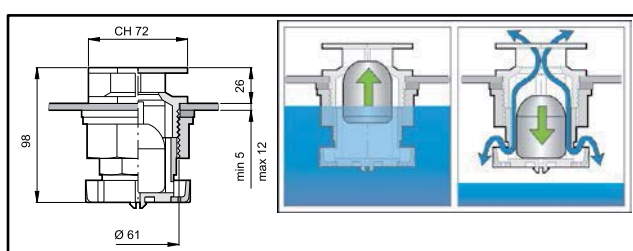

Valvola in PVC
PVC valve
Válvula de PVC



COD.
CODE
CÓD.
504 201

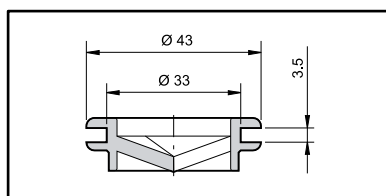

Valvola di sfiato a labirinto
Labyrinth breather valve
Válvula respiradero de laberinto



COD.
CODE
CÓD.
504 203

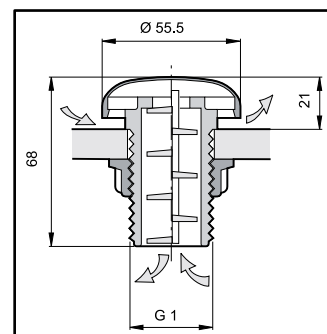

Rubinetto lava mani

- Corpo in polipropilene
- Guarnizioni in NBR

Hand washing cock

- Polypropylene body
- Gaskets in NBR

Grifo lava manos

- Cuerpo en polipropilene
- Juntas en NBR



COD. CODE CÓD.	F	Uscita Outlet Salida	s	
555 3018	G 3/4 BSP	17.5 mm	10 mm	10

s = Tratto utile filetto (spessore max. tanica)
s = Maximum tank wall thickness
s = Espesor maximo de la cisterna



COD. CODE CÓD.	F	Uscita Outlet Salida	s	
555 3009	G 3/4 BSP	8.5 mm	10 mm	10

s = Tratto utile filetto (spessore max. tanica)
s = Maximum tank wall thickness
s = Espesor maximo de la cisterna